

SN-IPV56/41UDN

4MP Vandal Network Dome



Key features

- 1/3" Progressive Scan CMOS
- VF Lens 3.0-12mm
- 4MP@15fps, 3MP@20fps, 1080P@30fps
- Triple Streams
- Low bitrate ,Excellent low light performance
- 3D DNR, dWDR, ICR
- ROI, Defog, HLC, Corridor mode, DIS

Dimension

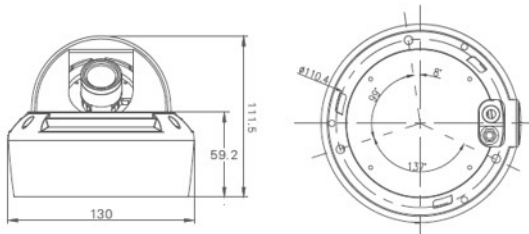

Accessories



SN-CBK629A SN-CBK633 SN-CBK623 SN-CBK624



SN-CBK627B SN-CBK625 SN-CBK626 SN-CBK633B

Specifications

CAMERA	
Image Sensor	1/3" Progressive Scan CMOS
Min. illumination	Color 0.05Lux@(F1.2, AGC ON); B&W 0.005Lux@(AGC ON)
Day & Night	ICR
Shutter Speed	1/5-1/20000
Auto Iris	Default Fixed ,Auto Iris Optional
Wide Dynamic Range	dWDR
Digital Noise Reduction	2D/3D
Lens	3.0-12mm VF Lens
FOV	87° ~ 35°
IR LED	N/A
IR Range	N/A
IMAGE	
Video Compression	H.264 High/Main/Baseline Profile, MJPEG
Bit Rate (CBR/VBR)	Main stream: 500kb-12000kb ; Sub stream 100kb-6000kb
Audio Compression	G.711 ,RAW_PCM
Max. Resolution	2688*1512/2560*1440/15fps, 2304*1296/20fps, 1920x1080/30fps
Stream	Stream1 2688*1512/2560*1440/2304*1296/1920x1080 Stream 2 720p to QVGA
Image Setting	Rotate Mode, Saturation, Brightness, Contrast, Sharpness
HLC	Yes
9:16 Corridor mode	Yes
DIS	Auto
ROI	Yes
Defog	Yes
NETWORK	
Network Protocols:	IPv4, 802.1x, HTTP, HTTPS, TCP/IP, UDP/IP, RTSP, DHCP, NTP, RTCP/RTP, PPPoE, SMTP, DNS, UPnP, FTP, ICMP, IGMP, Unicast and Multicast
Alarm Trigger	Motion Detection , Line Crossing, Tamper, Area Intrusion, Network disconnect, Disk alarm , I/O alarm
RTSP Video	Standard RFC2326, Support QuickTime / VLC Player.
Security	User security authentication, Reset, Hardware Watch Dog
Web Language	English, Chinese, Polish, Italian, Portuguese, Spanish, Russian, French, Czech, Hungarian (Sunell Brand)
System Compatibility	Onvif
INTERFACE	
Ethernet	1 Ethernet (10/100 Base-T) RJ-45 Connector
Audio I/O	Default Not support , Optional 1ch Audio In & 1ch Audio Out
Alarm I/O	Default Not support , Optional 1ch Alarm In/Out
RS485	N/A
BNC Output	Yes
Reset Button	Yes
Edge Storage	Micro SD/SDHC/SDXC slot , Max 64GB
GENERAL	
Power Supply	DC12V/POE/AC24V
Power Consumption	3W
Operating Temperature	Starting Temperature: -30 °C ~ 60 °C (-22 °F ~ 140 °F) Working Temperature: -40 °C ~ 60 °C (-40 °F ~ 140 °F)
Operating Humidity	0% - 90% RH
Ingress Protection	IP67, IK10
Approvals	CE / FCC
Product Dimensions	φ 130×112mm
Product Weight	900g