

## DP-2816HFI-ST

## Embedded Hybrid DVR

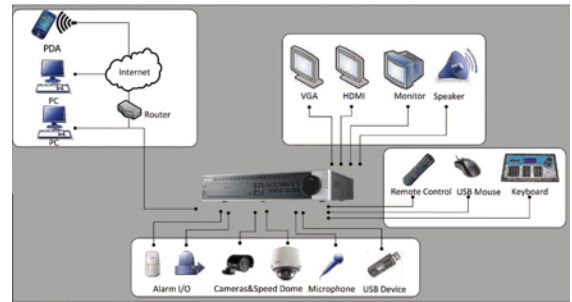

### Key features

- H.264 video compression
- Third-party network cameras supported
- Up to 5 Megapixels resolution recording
- HDMI and VGA output at up to 1920x1080P resolution
- 8/16-ch synchronous playback
- HDD quota and group management

### Rear Panel of DS-8016HFI-ST

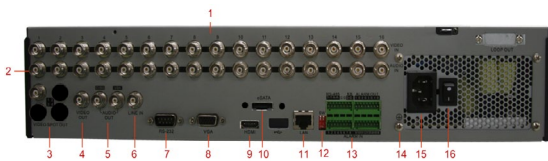

1. Video in
2. Audio in
3. Video spot out
4. Video out
5. Audio out
6. Line in
7. RS-232
8. VGA interface
9. HDMI interface
10. eSATA interface
11. LAN interface
12. Termination switch
13. RS-485 serial interface, keyboard interface, alarm in, alarm out
14. GND
15. 100 ~ 240 VAC
16. POWER

### Specifications

DO,1705GE,RS	
<b>Video / Audio input</b>	
Video compression	H.264
Analog video input	05-ch, BNC (1.0 Vp-p, 75 Ω), PAL /NTSC self-adaptive
IP video input	21-ch
Composited video input	Up to 21-ch (Analog video + IP video)
Audio compression	OggVorbis
Audio input	05-ch, BNC (2.0 Vp-p, 1 kΩ)
Voice talk input	1-ch, BNC (2.0 Vp-p, 1 kΩ)
<b>Video / Audio output</b>	
HDMI output	1-ch, resolution: 1920 × 1080P / 60 Hz, 1920 × 1080P / 50 Hz, 1600 × 1200 / 60 Hz, 1280 × 1024 / 60 Hz, 1280 × 720 / 60 Hz, 1024 × 768 / 60 Hz
VGA output	1-ch, resolution: 1920 × 1080P / 60 Hz, 1600 × 1200 / 60 Hz, 1280 × 1024 / 60 Hz, 1280 × 720 / 60 Hz, 1024 × 768 / 60 Hz
CVBS output	1-ch, BNC (1.0 Vp-p, 75 Ω), resolution: PAL: 704 × 576, NTSC: 704 × 480
Video spot output	1-ch, BNC (1.0 Vp-p, 75 Ω), resolution: PAL: 704 × 576, NTSC: 704 × 480
Video loop out	Optional
Encoding resolution	4CIF / 2CIF / CIF / QCIF
Frame rate	25 fps (P) / 30 fps (N)
Video bit rate	32 Kbps ~ 8192 Kbps, or user defined (Max. 8192 Kbps)
Audio output	2-ch, BNC (Linear, 600 Ω)
Audio bit rate	16 Kbps
Dual-stream	Support   (Sub-stream at CIF/QCIF: 25fps (P)/30fps (N))
Stream type	Video, Video & Audio
Playback resolution	5Megapixels / 3Megapixels / 1080P / UXGA / 720P / 4CIF / VGA / DCIF / 2CIF / CIF / QCIF
Synchronous playback	05-ch
<b>Hard disk</b>	
SATA	Up to 8 SATA interfaces
eSATA	1 eSATA interface
Capacity	Up to 4TB capacity for each disk
<b>External interface</b>	
Network interface	1 RJ45 10M / 100M / 1000M Ethernet interface
Serial interface	1 RS-232 interface (for parameters configuration, maintenance, transparent channel); 1 RS-485 interface (for PTZ control); 1 RS-485 keyboard interface (for special keyboard control)
USB interface	2, USB2.0
Alarm in	05
Alarm out	3
<b>General</b>	
Power supply	100 ~ 240 VAC, 6.3A, 50-60Hz
Consumption	≤ 34 W
Working temperature	-10 °C ~ +55 °C
Working humidity	10% ~ 90%
Chassis	19-inch rack-mounted 2U chassis
Dimensions (W × D × H)	445 × 470 × 90 mm
Weight	≤ 8kg (without hard disk or DVD-R/W)