

# DS-6504/6508/6516HFI-SATA Digital Video Server

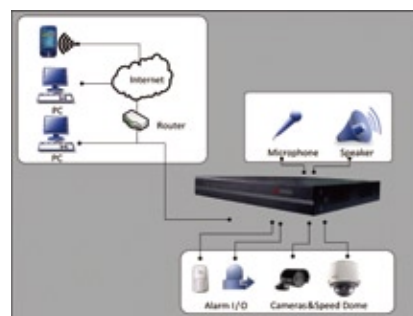

## Key Features

- High performance DSP hardware compression
- H.264 video compression
- Dual stream
- Variable bit rate and frame rate
- Multi-zone motion detection and private masking
- Multi-level user access management
- 1 SATA interface for local storage



## Specifications

		DS-6504HFI-SATA	DS-6508HFI-SATA	DS-6516HFI-SATA
Video/Audio input	Video Compression	H.264		
	Video input	4-ch, BNC(1Vp-p, 75Ω)	8-ch, BNC(1Vp-p, 75Ω)	16-ch, BNC(1Vp-p, 75Ω)
	Audio compression	OggVorbis		
	Audio input	4-ch, BNC(2Vp-p, 1kΩ)	8-ch, BNC(2Vp-p, 1kΩ)	16-ch, BNC(2Vp-p, 1kΩ)
	Voice talk input	1-ch, MIC connector(2Vp-p, 1kΩ)		
Video/Audio output	Video loop out	DB26 connector (Optional)		
	Audio output	1-ch, MIC connector		
	Recording resolution	QCIF/CIF/2CIF /DCIF/4CIF	QCIF/CIF/2CIF/4CIF	
	Frame rate	QCIF/CIF/2CIF /DCIF/4CIF: 25(P)/30(N)	QCIF/CIF/2CIF/4CIF: 25(P)/30(N)	
	Video bit rate	32Kps~2048Kbps, or user-defined (Max.3Mbps)		
Hard disk	Dual Stream	Supported		
	Stream Type	Video/ Video&Audio		
	Type	SATA interface		
External interface	Capacity	Up to 2TB		
	Network interface	1RJ45 10/100/1000Mbps self-adaptive UTP Ethernet interface		
	Serial interface	1 RS485, 1 RS232(DB9 Port)		
	USB interface	-		
	SATA interface	1		
Others	Alarm in	16		
	Alarm out	4		
	Chassis	1U, 19-inch; Rear panel provides Reset button		
	Power supply	100~240VAC, 6.3A, 50~60Hz		
	Consumption	≤40W (without HDD)		
	Working temperature	-10°C~+55°C(14°F~131°F)		
	Working humidity	10%~90%		
Dimension	440(D)×300(W)×45mm(H)(17.32"(D)×11.81(W)×1.77"(H))			
Weight(without HDD)	≤5000g(11.02lbs)			