

DS-7608NI-S Embedded NVR



Key Features

- H.264/MPEG-4 video stream input
- Up to 5 Megapixels (2560×1920) resolution
- VGA output at 1024×768 resolution
- 4-ch synchronous playback
- HDD group management
- 2 SATA interfaces

Specifications

DS-7608NI-S	
Video / Audio input	
IP Video input	8-ch 4CIF real time or 4-ch 720P / UXGA / 1080P real time or 2-ch 2560×1920 not real time
Audio input	1-ch, RCA(2.0 Vp-p, 1 kΩ), for voice talk input
Video / Audio output	
VGA output	1-ch, resolution: 1024×768 /60 Hz
Playback resolution	2560×1920 / UXGA / 1080P / 720P / 4CIF / VGA / DCIF / 2CIF / CIF / QCIF
Video output	1-ch, BNC (PAL: 704×576, NTSC: 704×480)
Frame rate	25fps (P) / 30fps (N)
Video bit rate	32Kbps~2048Kbps, or user defined (max. 16384 Kbps)
Audio output	1-ch, RCA(2.0 Vp-p, 1 kΩ), for voice talk output
Audio bit rate	16kbps
Synchronous playback	4-ch
Hard disk	
SATA	2 SATA interfaces
Capacity	Up to 2TB capacity for each disk
External interface	
Network interface	1, RJ45 10M / 100M self-adaptive ethernet interface
Serial interface	1 RS-485 interface
USB interface	2, USB2.0
Alarm in	4
Alarm out	1
General	
Power supply	12 VDC
Consumption	≤ 12W (without hard disk or DVD-R/W)
Working temperature	-10 °C ~ +55 °C
Working humidity	10%~90%
Dimensions (W x D x H)	445 × 290 × 44 mm
Weight	≤ 8kg (without HDD or DVD-R/W)

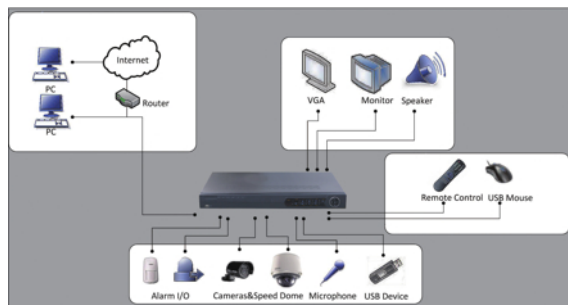

Rear Panel of DS-7608NI-S



- | | |
|------------------|--|
| 1. USB interface | 6. VGA interface |
| 2. Video out | 7. RS-485 interface, alarm in, alarm out |
| 3. Audio in | 8. 12 VDC power supply |
| 4. Audio out | 9. GND |
| 5. LAN | 10. Power switch |