

DS-7708/7716/7732NI-ST Embedded NVR

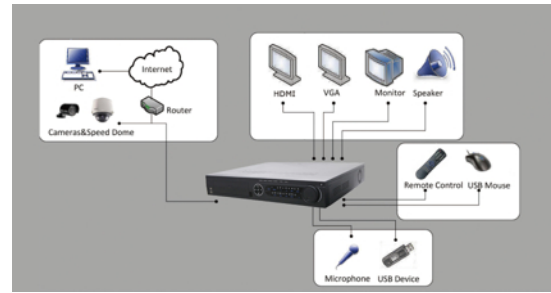

Key features

- Up to 8/16/32-ch IP cameras input
- Third-party network cameras supported
- Up to 5 Megapixels resolution recording
- HDMI and VGA output at up to 1920×1080P resolution
- HDD quota and group management
- 4 SATA, 2 USB2.0

Rear Panel of DS-7700NI-ST

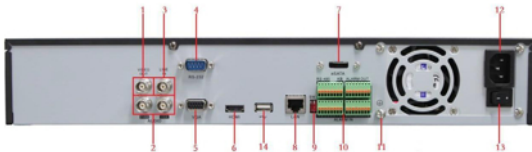

1. Video out
2. CVBS Audio out and VGA audio out
3. Line in
4. RS-232 interface
5. VGA interface
6. HDMI interface
7. eSATA interface
8. LAN interface
9. Termination switch
10. RS-485 interface, Controller port, Alarm in and Alarm out
11. Ground
12. AC 100V ~ 240V
13. Power
14. USB interface

Specifications

	DS-7708NI-ST	DS-7716NI-ST	DS-7732NI-ST
Video / Audio input			
IP video input	8-ch	16-ch	32-ch
Two-way audio	1-ch, BNC (2.0 Vp-p, 1kΩ)		
Video / Audio output			
Recording resolution	5MP /3MP /1080P /UXGA /720P /VGA /4CIF /DCIF /2CIF /CIF /QCIF		
CVBS output	1-ch, BNC (1.0 Vp-p, 75 Ω) Resolution: 704 × 576 (PAL); 704 × 480 (NTSC)		
HDMI output	1-ch, resolution: 1920 × 1080P /60Hz, 1920 × 1080P /50Hz, 1600 × 1200 /60Hz, 1280 × 1024 /60Hz, 1280 × 720 /60Hz, 1024 × 768 /60Hz		
VGA output	1-ch, resolution: 1920 × 1080P /60Hz, 1600 × 1200 /60Hz, 1280 × 1024 /60Hz, 1280 × 720 /60Hz, 1024 × 768 /60Hz		
Audio output	2-ch, BNC (Linear, 600Ω)		
Playback resolution	5MP /3MP /1080P /UXGA /720P /VGA /4CIF /DCIF /2CIF /CIF /QCIF		
Synchronous playback	8-ch	16-ch	16-ch
Hard disk			
SATA	4 SATA interfaces for 2 HDDs + 1 DVD-R/W (default), or 4HDDs		
eSATA	1 eSATA interface		
Capacity	Up to 4TB capacity for each HDD		
External interface			
Network interface	1 RJ-45 10 /100 /1000 Mbps self-adaptive Ethernet interface		
Serial interface	1 RS-232 interface (for parameters configuration, maintenance, transparent channel); 1 RS-485 interface (reserved); 1 RS-485 keyboard interface (for special keyboard control)		
USB interface	3 × USB 2.0		
Alarm in	16		
Alarm out	4		
General			
Power supply	100~240VAC, 6.3A, 50~60Hz		
Consumption	≤ 35 W	≤ 40 W	≤ 45 W
Working temperature	-10 °C ~+55 °C		
Working humidity	10%~90%		
Chassis	19-inch rack-mounted 1.5U chassis		
Dimensions(W × D × H)	440 × 390 × 70mm		
Weight	≤ 4 Kg (8.82 lb) (without hard disk or DVD-R/W)		