

DS-9004/9008/9016HFI-RH Embedded Hybrid DVR

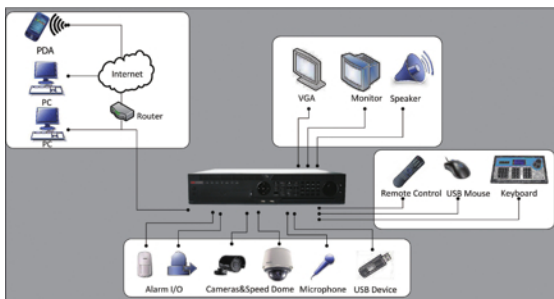

Key Features

- H.264 video compression
- Third-party network cameras supported
- HDMI output at 1920×1080 resolution
- 4/8/16-ch synchronous playback
- RAID 0, RAID 1, RAID 10 & RAID 5 supported
- Easy HDD assembly & replacement



Specifications

	DS-9004HFI-RH	DS-9008HFI-RH	DS-9016HFI-RH
Video / Audio input			
Video compression	H.264		
Analog video input	4-ch, BNC (1.0 Vp-p, 75 Ω), PAL/NTSC self-adaptive	8-ch, BNC (1.0 Vp-p, 75 Ω), PAL/NTSC self-adaptive	16-ch, BNC (1.0 Vp-p, 75 Ω), PAL/NTSC self-adaptive
IP video input	4-ch 4CIF / 2-ch 720P / 1-ch UXGA real time	8-ch 4CIF / 4-ch 720P / 2-ch UXGA real time	16-ch 4CIF / 8-ch 720P / 4-ch UXGA real time
Composited video input	8-ch (4-ch analog video + 4-ch IP video)	16-ch (8-ch analog video + 8-ch IP video)	24-ch (16-ch analog video + 8-ch IP video)
Audio compression	OggVorbis		
Audio input	4-ch, BNC (2.0 Vp-p, 1 kΩ)	8-ch, BNC (2.0 Vp-p, 1 kΩ)	16-ch, BNC(2.0 Vp-p, 1 kΩ)
Voice talk input	2-ch, BNC (2.0 Vp-p, 1 kΩ)		
Video / Audio output			
Preview resolution	PAL: 704×576, NTSC: 704×480		
HDMI output	1-ch, Resolution: 1024 × 768 /60 Hz, 1280 × 1024 /60 Hz, 1920 × 1080 /60 Hz		
VGA output	1-ch, Resolution: 1024 × 768 /60 Hz, 1024 × 768 /70 Hz, 1280 × 1024 /60 Hz		
Encoding resolution	4CIF / DCIF / 2CIF / CIF / QCIF		
Video output	2-ch, BNC (1.0 Vp-p, 75 Ω)		
Video loop out	Optional		
Frame rate	25 fps(P)/30 fps(N)		
Video bit rate	32 Kbps-2048 Kbps, or user defined (Max. 6144 Kbps)		
Audio output	2-ch, BNC (Linear Electrical Level, 600 Ω)		
Audio bit rate	16 Kbps		
Dual-stream	Support		
Stream type	Video, Video & Audio		
Synchronous playback	4-ch	8-ch	16-ch
Hard disk			
SATA	8 SATA interfaces		
Capacity	Up to 2TB capacity for each disk		
Array type	RAID 0, RAID 1, RAID 5, RAID 10		
Array number	4		
Virtual disk	8		
External interface			
Network interface	1, RJ45 10 M / 100M / 1000M self-adaptive ethernet interface		
Serial interface	1 RS-232 interface (for parameters configuration, maintenance, transparent channel);1 RS-485 interface (for PTZ control);1 RS-485 keyboard interface (for special keyboard control)		
USB interface	3, USB 2.0		
Alarm in	16		
Alarm out	4		
General			
Power supply	100 ~ 240 VAC, 6.3A, 50-60Hz		
Consumption	≤ 70W (without hard disk or DVD-R/W)		
Working temperature	-10 °C ~ +55 °C		
Working humidity	10% ~ 90%		
Dimensions (W × D × H)	445 × 470 × 90 mm		
Weight	≤ 8kg (without hard disk or DVD-R/W)		

Rear Panel of DS-9016HFI-RH

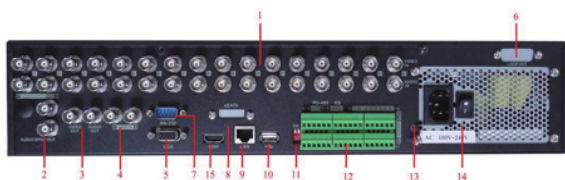

1. Video in, audio in
2. Video spot out (for video preview only), Audio spot out
3. Video out, audio out
4. Line in
5. VGA interface
6. Loop out (optional)
7. RS-232 serial interface
8. eSATA backup / extended storage interface (optional)
9. LAN network interface
10. USB interface
11. RS-485 matched resistance switch
12. RS-485 serial interface, keyboard interface (support cascade), alarm in, alarm out
13. GND
14. 100-240 VAC power input
15. HDMI interface