

FW1175-FM

H.264/MJPEG 2M Motorized Vandal Dome Camera

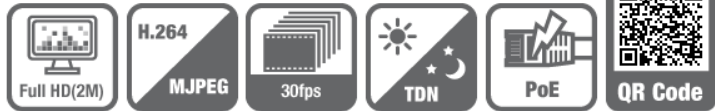

Key Features

- 1/2.9" 2.43M PS CMOS Sensor
- 2.8-10mm(F1.2) V/F 2Motor Lens / 3.5-16mm(F1.2) V/F 2Motor Lens
- Min. Illumination: 0.0016Lux
- Max. 30fps@2M(1920x1080)
- Dual Stream(H.264, MJPEG)
- Onboard storage by Micro SD
- Built-in PoE (Optional)

Supports both ONVIF(ProfileS) and PSIA(v1.0) standards.

| | |
|-----------------------------|--|
| Video Encoding | H.264/MJPEG(simultaneous dual stream) H.264/H.264 (true H.264 dual streaming) Simultaneous streaming with independent control |
| Video signal | 1 Analog(NTSC only) Output (Optional) |
| Resolution | 1920x1080, 1280x720, 640x352, 320x176, 160x96 |
| Live Casting | Streaming video channels with full duplex live audio Up to max 30fps@ 2M when simplex |
| Audio Encoding | 8bit G.711, 8Khz, 8KByte/sec |
| Audio channels | 1ch audio-in & 1ch audio-out |
| PTZ support | PTZ and UART device control through serial port(RS232 / RS485) (Support protocols; Pelco "P" & "D", Vicon V1311RB, Samsung PTZ, Honeywell PTZ and X10 and Epson Printer) |
| Serial Interface | COM Port: RS-232, for console, serial input/output device AUX Port for PTZ or other RS485 device Max. Baud rate: 115200 bit/s |
| Bandwidth Management | Frame rate control / Bandwidth control / CBR / VBR |
| Alarm Management | [Trigger Condition] Video loss / Video recovered / Motion detection (144 area) / Boot finished / Schedule [Alarm Service] Image holding service (Max 5.6MByte pre-post alarm buffer), Image upload service through E-mail / FTP (support pre & post), Notification service through TCP / UDP / HTTP |
| Security | Channel based user password protection for live-cast, PTZ, alarm output and audio |
| Dynamic IP | Dynamic IP service using www.ipcctvdns.com |
| Smart Solution | Smart Phone Application (IOS, Android) |
| Web interface | Live-cast, PTZ control, search through Web browser Minimum PC requirement - Windows XP Pro (IE 6.x or later) , Pentium4 (2Ghz, 2G RAM), Video Card(256MB RAM, 1024x768) |
| Management Software | Supports 16, 32, 64, 128ch Management Software Full-featured PC NVR with matrix functionality |
| System Integration | [Protocol] HTTP, RTP/RTSP, TCP/IP, FTP, Telnet, RARP, PPPoE, SNMP, PAP, CHAP, DHCP, NTP, SMTP client, uPNP, and etc. [SDK] Open HTTP API / ActiveX for live cast with audio & PTZ [Service] Image upload / notification service / service for POS integration |

| | |
|---------------------------------------|---|
| Installation & maintenance | Configuration by installation wizard, HTTP, telnet and console. Upgrade firmware through HTTP, telnet & FTP |
| Misc. | Transmit serial input data with video Quick Time & VLC media player compatible |
| System hardware | 32bit Embedded CPU / Embedded Linux / 128MByte SDRAM / 128MByte NAND Flash |
| Power | Power Supply - SMPS 12V (1A) [AC100~240V, 50/60Hz, 300mA] Max. Power Consumption - DC12V, 9.6W |
| Approvals | IP66, KC, FCC, CE, RoHS |
| Dimension / Weight | 148 Ø x 121 (H) (in mm) (1.0 kg impact-resistant casing) 940g without Power Supply |
| External Interface | 10/100-Base-T Ethernet (auto-sensing) 1 photo-coupled or 1 digital inputs (NC/NO selectable), 1 relay outputs 1 audio input / 1 audio output 2 serial ports (COM: RS-232, AUX: RS-485) 1 Micro SD memory interface Factory Default Button |
| Working Environment | Temperature: -10~50 °C, Humidity: 10~90% RH |
| Image sensor | 1/2.9" progressive scan CMOS Total number of pixels: 2000Hx1241V=2.48M Pixel size : 2.5 8 (H) µm × 2.5 8 (V) µm Color filter Bayer arrangement of primary colors: R, G, B Bit number of internal ADC: 10/12 bits Parallel output: 37.125 MHz, 10/12 bits Maximum frame rate in all-pixel scan mode: 60/30 fps |
| Lens | 2.8-10mm, V/F, 2Motor, F1.2 / 3.5-16mm, V/F, 2Motor, F1.2 |
| Image Setting | Day & Night (Auto/B&W/Off) Auto White Balance Noise Filter (Off/On) Brightness/Contrast/Sharpness/AGC Gain Control Lens Type (DC/Manual) Shutter (Manual/Auto) Vertical/Horizontal Flip Sens Up Level Frequency Control (50/60) |
| Minimum illumination | 0.0016 Lux |
| Options | Built-in PoE (IEEE 802.3af) |

Dimensions

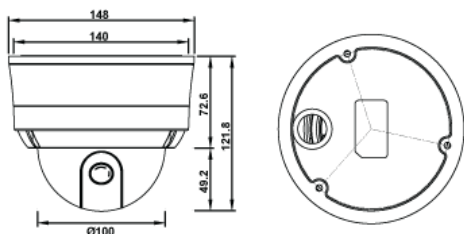

Accessory

