

## DS-2CD893PF(NF)-E(W) CCD-based Network Camera

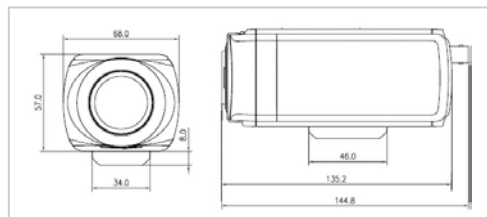

- Real time video at 4CIF resolution
- H.264/MJPEG video compression with high compression ratio
- Up to 32 GB SD/SDHC card local storage
- Two-way audio
- PoE

Unit: mm

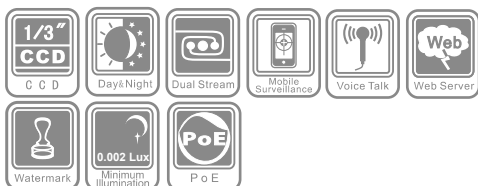

### Specifications

|                      |                         |   |
|----------------------|-------------------------|---|
|                      |                         | DS-2CD893PF(NF)-E(W)  |
| Camera               | Image Sensor            | 1/3" SONY CCD   |
|                      | Signal System           | PAL/NTSC  |
|                      | Min. Illumination       | Color:0.02Lux@ F1.2<br>B/W:0.002Lux@ F1.2   |
|                      | Electronic Shutter      | 1/25(1/30)s ~1/100,000s   |
|                      | Lens Mount              | C/CS mount  |
|                      | Auto Iris               | DC Drive  |
|                      | Day &Night              | IR cut filter with auto switch  |
| Compression Standard | Video Compression       | H.264/MJPEG   |
|                      | Bit rate                | 32 Kbps~8Mbps   |
|                      | Audio Compression       | OggVorbis   |
| Image                | Max. Image Resolution   | PAL: 704×576<br>NTSC: 704×480   |
|                      | Frame Rate              | 50HZ: 25fps (704×576)<br>60HZ: 30fps (704×480)  |
|                      | Image Settings          | Saturation, Brightness, Contrast adjustable through client software or web browser                  |
| Network              | Storage                 | Support SD/SDHC, NAS(ISCISI optional)   |
|                      | Intelligent Alarm       | Motion Detection, Video Loss, Network Disconnect, IP address conflict, Storage exception            |
|                      | Protocols               | TCP/IP,HTTP,DHCP,DNS,DDNS,RTSP,RTSP, PPPoE, SMTP, NTP (SNMP,HTTPS, FTP, SIP, 802.1x, IPv6 optional) |
|                      | Basic                   | Reset button, Anti-flicker, Dual Stream, Heartbeat, Password Protection, watermark                  |
| Interface            | Audio Input             | 1 channel microphone input, 3.5mm mini-jack   |
|                      | Audio Output            | 1 channel 3.5mm audio interface (Line level, 600Ω)  |
|                      | Communication Interface | 1 RJ45 10M / 100M self-adaptive Ethernet interface and 1 RS-485 interface                           |
|                      | Alarm Input             | 1 channel   |
|                      | Alarm Output            | 1 channel   |
| General              | Video Output            | 1Vp-p Composite Output (75Ω/BNC)  |
|                      | Operating Condition     | -10°C~60°C(14°F~140°F), Humidity 90% or less(non-condensing)  |
|                      | Power Supply            | DC12V±10% / PoE (AC24V optional)  |
|                      | Power Consumption       | 5.5W MAX(10.5W MAX with ICR Working)  |
|                      | Dimension               | 68×57×144.8mm (2.68"×2.24"×5.70")   |
| Weight               | 500g (1.1lbs)           |   |

### Available Models

DS-2CD893PF-E, DS-2CD893PF-EW, DS-2CD893NF-E, DS-2CD893NF-EW

\*-W: support Wi-Fi function (802.11g)